

1 2 3 4 5 6

A

A

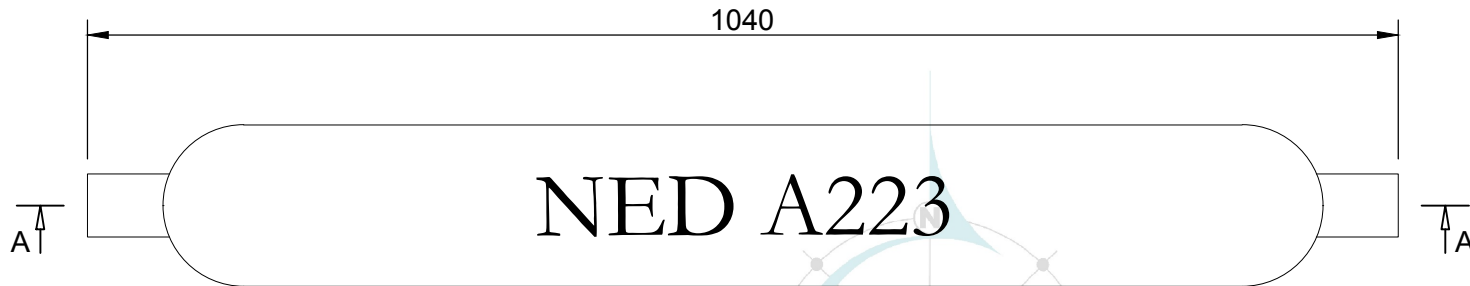

B

B

Section A-A

View A-A

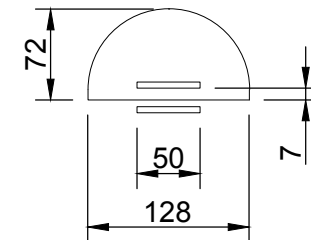
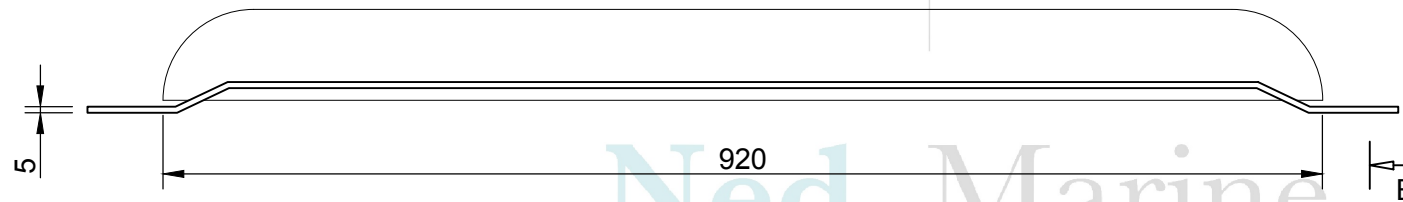

C

C

Ned Marine  
services B.V.

ALUMINIUM PL742 ALLOY SPECIFICATION

Components:

Zn 3,5-5% range  
Fe 0,16% max  
Cu 0,01% max  
In 0,02-0,05% max  
Si 0,1% max  
Others 0,04% max  
Al remaining

Capacity: 2680 Ah/kg

Efficiency: 90%

Potential: - 1110 mV Cu -

CuSO<sub>4</sub> electrolyte artificial sea water DIN 50905

Insert quality: Plate, bar section EN10025 Grade S235/S275

Insert welding: All fabrication of steel inserts are according EN10287 and EN10288

NET WEIGHT: 20,3 kg  
GROSS WEIGHT: 22,3 kg  
INSERT WEIGHT: 2,0 kg

Company address:  
Tinstraat 109  
2984AN Ridderkerk  
The Netherlands  
Tel. +31 (0) 180 420 055  
Fax. +31 (0) 180 499 810  
E-mail. info@nedmarine.com  
www.nedmarine.com



Drawing name: NED A223			
Drawing No.: 17.0129	Rev: 0	Sheet: 1/1	
Drawn: R.D.	Approved: G.M.	Scale: -	Date: 28/07/2017

D

1 2 3 4 5 A4

Ned T.D. 16 003